

# Lewisham



Borough Officer **Peter Stunell**

I have experience of a wide range of civil engineering work but I have been working in traffic engineering since 1985, latterly being responsible for cycling issues in Lewisham.

We have policies that encourage the use of bikes but with only 2% of commuting to work journeys and 1% journeys to educational establishments currently undertaken by cycle we have a lot to do. We have come from a low base but a number of cycle routes have been created or improved in recent years and our screen line counts show an increase in cycling of 24% in the morning peak and 14% on average through the day since 2001.

The work is often problematic with conflicting interests on the highway and other routes. There is always a struggle for the contractual and other resources to do work but real progress is being made with external help brought in.

We are roughly half way through our programme of CRISP studies with an eye to more improvements in future years. Network completion is 30%

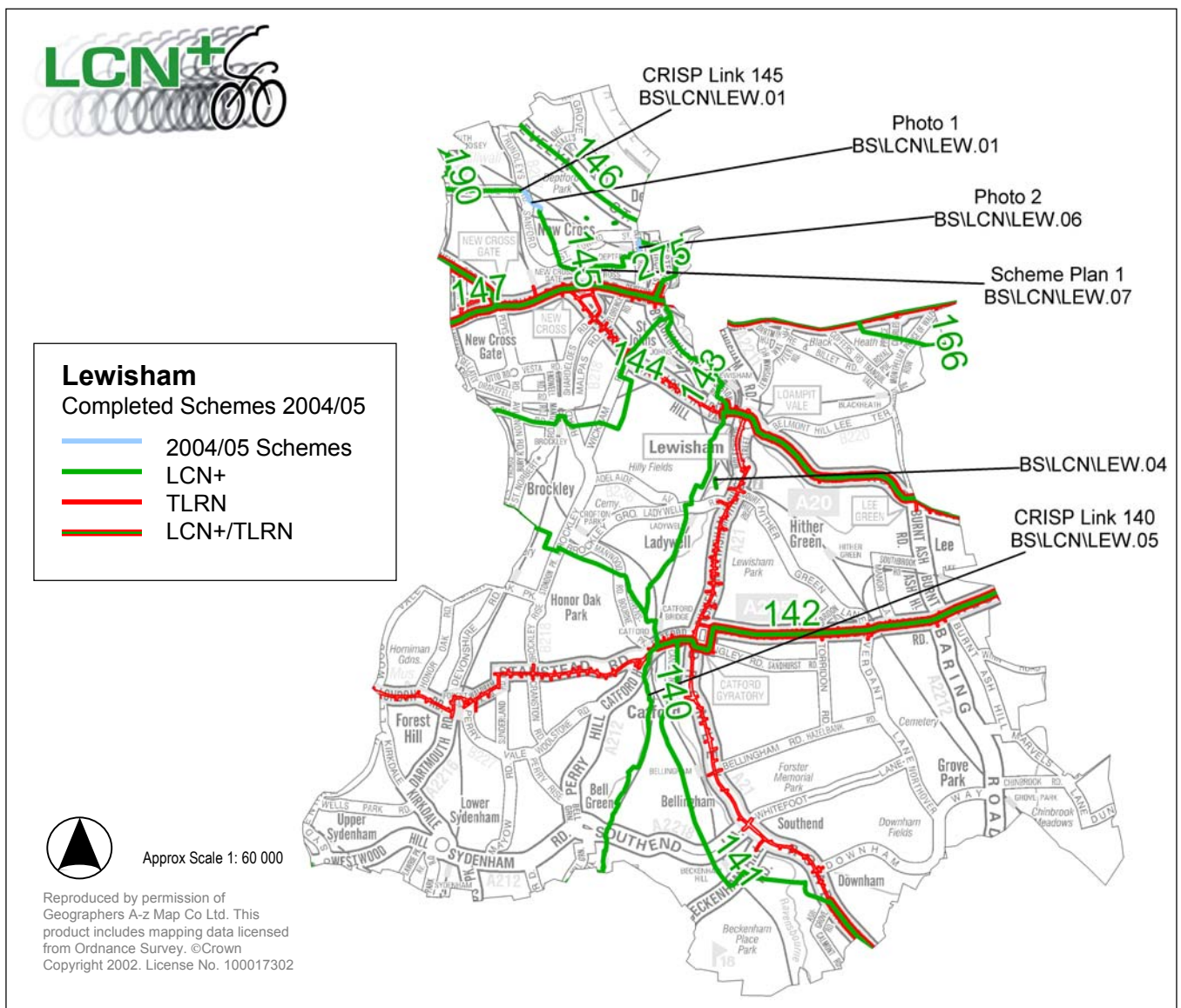

**CRISP BS\LCN\LEW.01 Link Number: 145**  
**CRIM undertaken: 22.11.05**  
**Final CRISP report: April 2005**  
**Cost: £9 000 (included in scheme cost) Length: 3.8km**

**CRISP BS\LCN\LEW.05 Link Number: 140**  
**CRIM undertaken: 12.7.05**  
**Final CRISP report: Summer 2005**  
**Cost: £13 608 Length: 5.26km**



◀ **Scheme Photo 1**

**Scheme Code:** BS\LCN\LEW.01  
**Link Number:** 145  
**Location:** Trundley Rd / Folkstone Gardens  
**Description:** Feasibility of crossing of the junction at Trundley's Rd; Implementation of lighting through Folkstone Gardens and CRISP Study of entire link.  
**Cost:** £43 779 (includes CRISP Study)  
**Length:** 0.27km

▼ **Scheme Photo 2**

**Scheme Code:** BS\LCN\LEW.06  
**Link Number:** 275  
**Location:** Deptford Church St  
**Description:** 2 way segregated cycle track (scheme completion from 2003/4) including lining and cycle logos along track  
**Cost:** £38 509 **Length:** 0.13km

**Scheme Code:** BS\LCN\LEW.04  
**Link Number:** 140  
**Location:** Wearside Depot  
**Description:** Investigation into providing a continuation of Waterlink Way riverside route to connect more directly with Lewisham town centre, station and DLR.  
**Cost:** £5 998 **Length:** 0.09km

▼ **Scheme Plan 1**

**Scheme Code:** BS\LCN\LEW.07  
**Link Number:** 145  
**Location:** Fordham Park  
**Description:** Design 2 way cycle track / shared path connecting with New Cross station and onward connection towards Deptford High Street.  
**Cost:** £3 640 **Length:** 0.28km

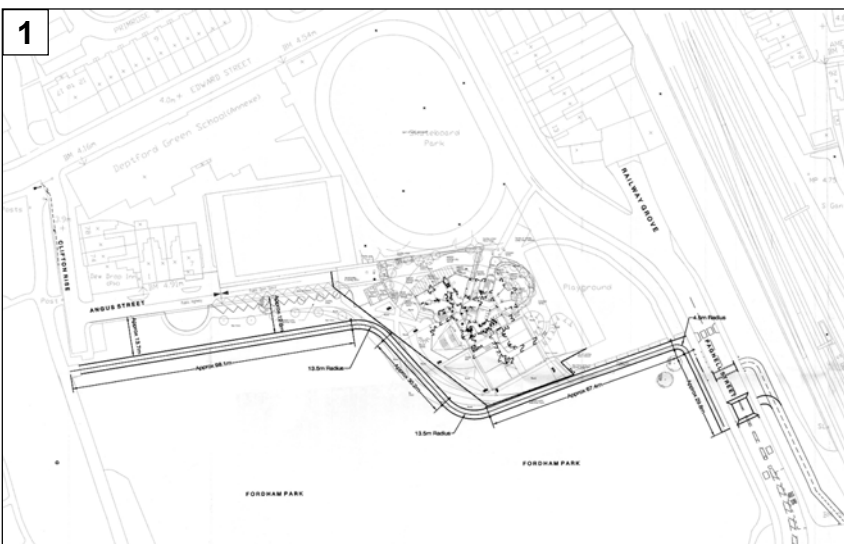

**Scheme Code:** BS\LCN\LEW. 03  
**Link Number:** 145  
**Location:** Clyde St school Area  
**Description:** Initial feasibility halted following outcomes of CRISP study with a new preferred route alignment.  
**Cost:** £630 **Length:** 0.03km

**Scheme Code:** BS\LCN\LEW.02  
**Link Number:** 145  
**Location:** Childers St, Clyde St  
**Description:** Initial feasibility halted following outcomes of CRISP study with a new preferred route alignment.  
**Cost:** £340 **Length:** 0.01km