

Westminster



City of Westminster

Borough Officer **Nigel Butterworth**

I have been with Westminster for 5 years. Before that I dealt with Traffic & Transport issues in various London Boroughs for about 25 years most of which had at least some cycling elements.

At the hub of London, Westminster is a great place to cycle, fairly flat and compact, not too much through traffic and traffic free routes through big parks. Car use is low in comparison with other areas especially with congestion charging.

It is very difficult to process cycle facilities due to the polarised attitudes between cyclists and non cyclists. Therefore those in authority are reluctant to encourage the development of measures to increase levels of cycling.

The LCN is largely complete in Westminster and twelve of these routes are now to be enhanced to LCN+ standards. TfL are responsible for three routes, which are on the TLRN. Of the remaining nine, one route has been improved and feasibility studies have been completed on five others. A CRISP study has started on one route with three others planned. Network completion is 20%.

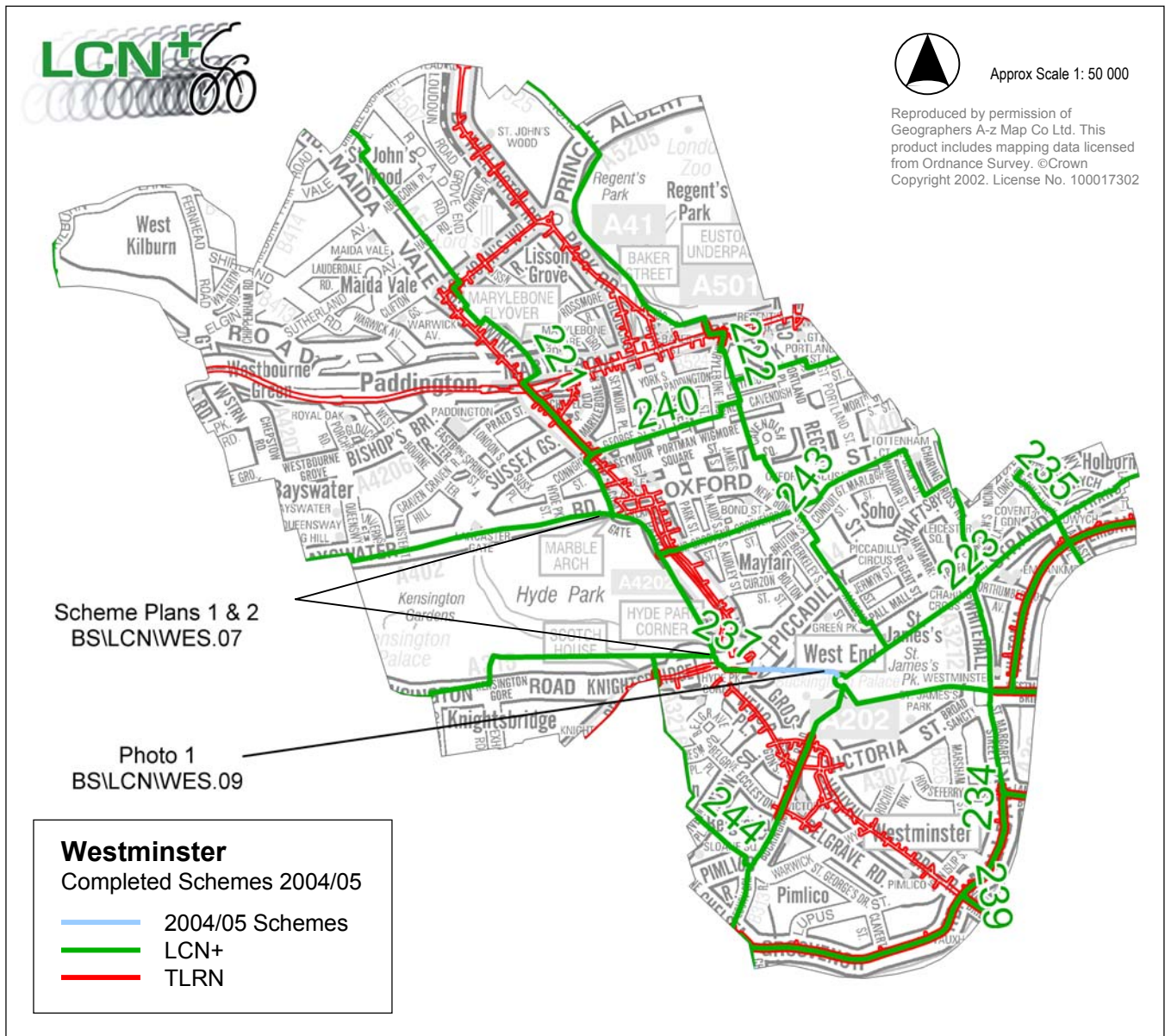

▼▼ Scheme Plans 1 & 2

Scheme Code: BS\LCN\WES.07

Link Number: 237, (241,240)

Location: The 7 Stations Circular Route which runs from Lambeth Bridge to Camden via Hyde Park. Plan 1: South Carriage Drive/Hyde Park Corner . Plan 2 : North Carriage Drive

Description: Development of designs North and South Carriage Drive Schemes and other section of route. CRISP started on links 240 & 241(between George St and Camden Borough Boundary)

Cost: £130 000 **Length:** 0.11km

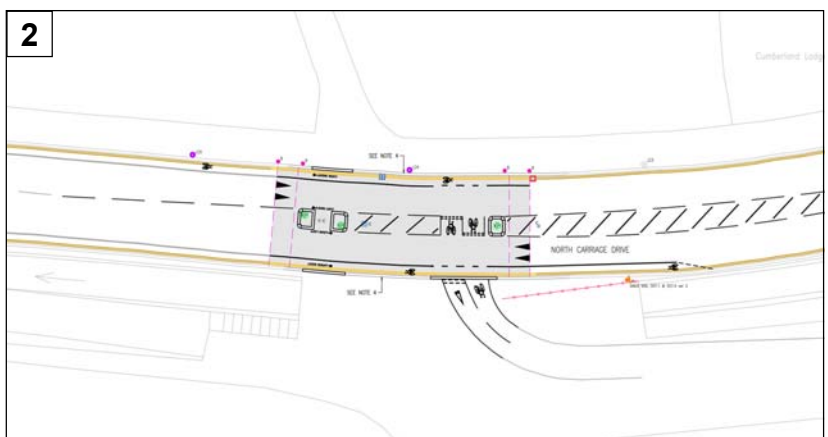
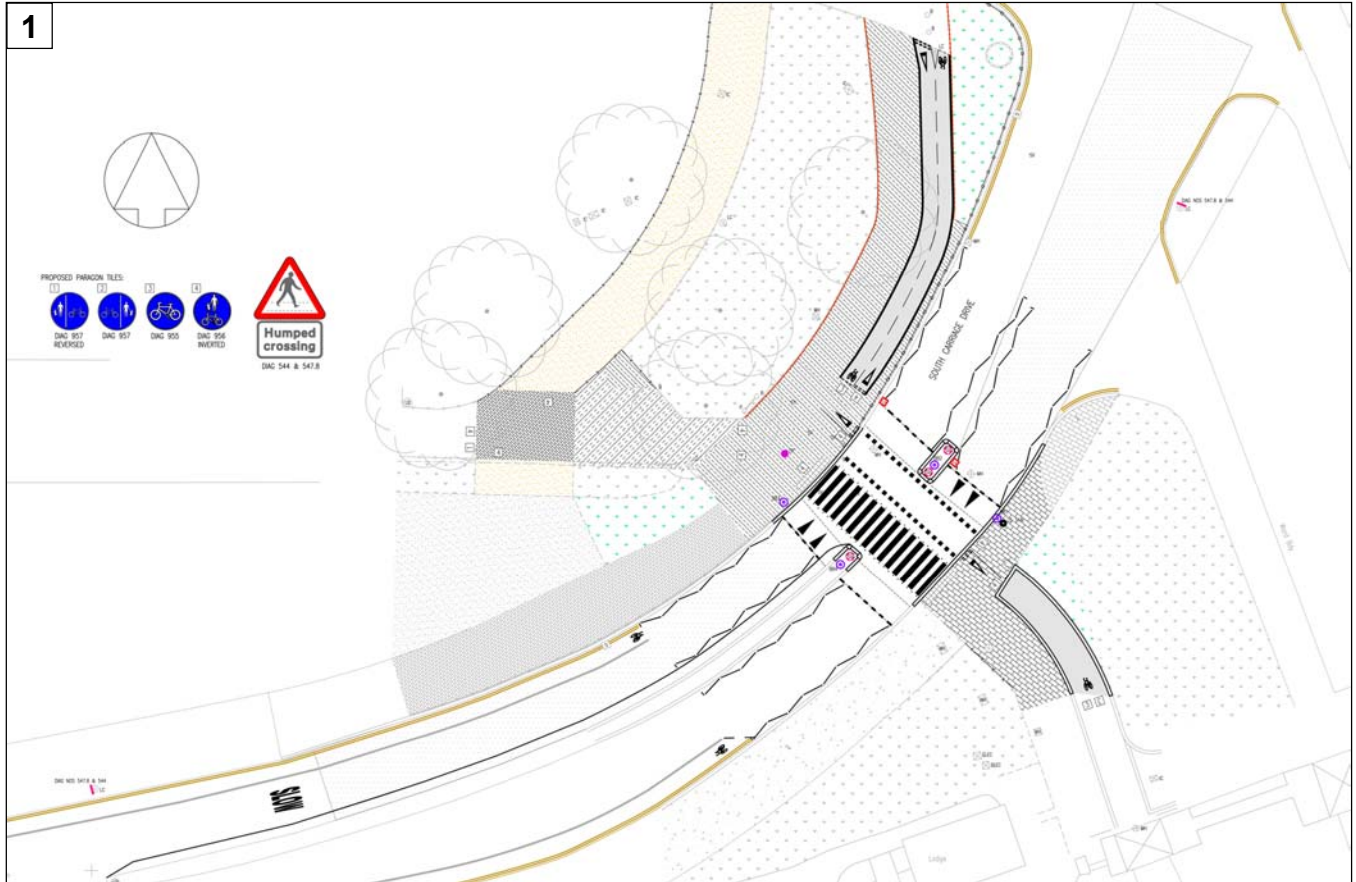

◀ Scheme Photo 1

Scheme Code BS\LCN\WES.09

Link Number: 237 **Location:**

Constitution Hill

Description: Resurfacing cycle lane

Cost: £15 000 **Length:** 0.59km

Scheme Code:

BS\LCN\WES.08

Link Number: 237, 221,
243 & 222

Location: routes 5, 39 & 50

Description: Continuation of
consultation

Cost: £10 000