

Kingston Upon Thames



Borough Officer: **Robert Parsey** and **John Martin**



The Sustainable Transport Unit in the Royal Borough of Kingston upon Thames has experienced and dedicated officers responsible for the delivery of the LCN+.



Rob Parsey has been RBK's cycling officer for 5 years. John Martin, Sustainable Transport Manager, led the SW Sector until 2006. Every opportunity is taken to introduce cycle

facilities as part of London Bus Priority Network schemes, which maximises the benefits for people undertaking journeys by bicycle and public transport. RBK works closely with consultants in the CRISP study process, which is a useful tool for identifying and time-tabling improvements to existing LCN+

routes in the Borough. This has helped to strengthen partnership working with the Kingston Cycling Campaign, TfL (Road Network Development & Management), and other stakeholders. The completion of the cycle network is well advanced in the Borough and so a significant increase in cycling levels become harder to achieve. The challenge of future works is in upgrading these routes, filling in 'missing links', and provision of secure off-street parking. Whilst recent localised schemes have had little significant effect on safety they have improved cycle route continuity. We have worked closely with Kingston Police & Kingston Town Centre Management to reduce levels of cycle theft especially in Kingston Town Centre, as cycle theft can be a major deterrent to people undertaking journeys by bicycle.

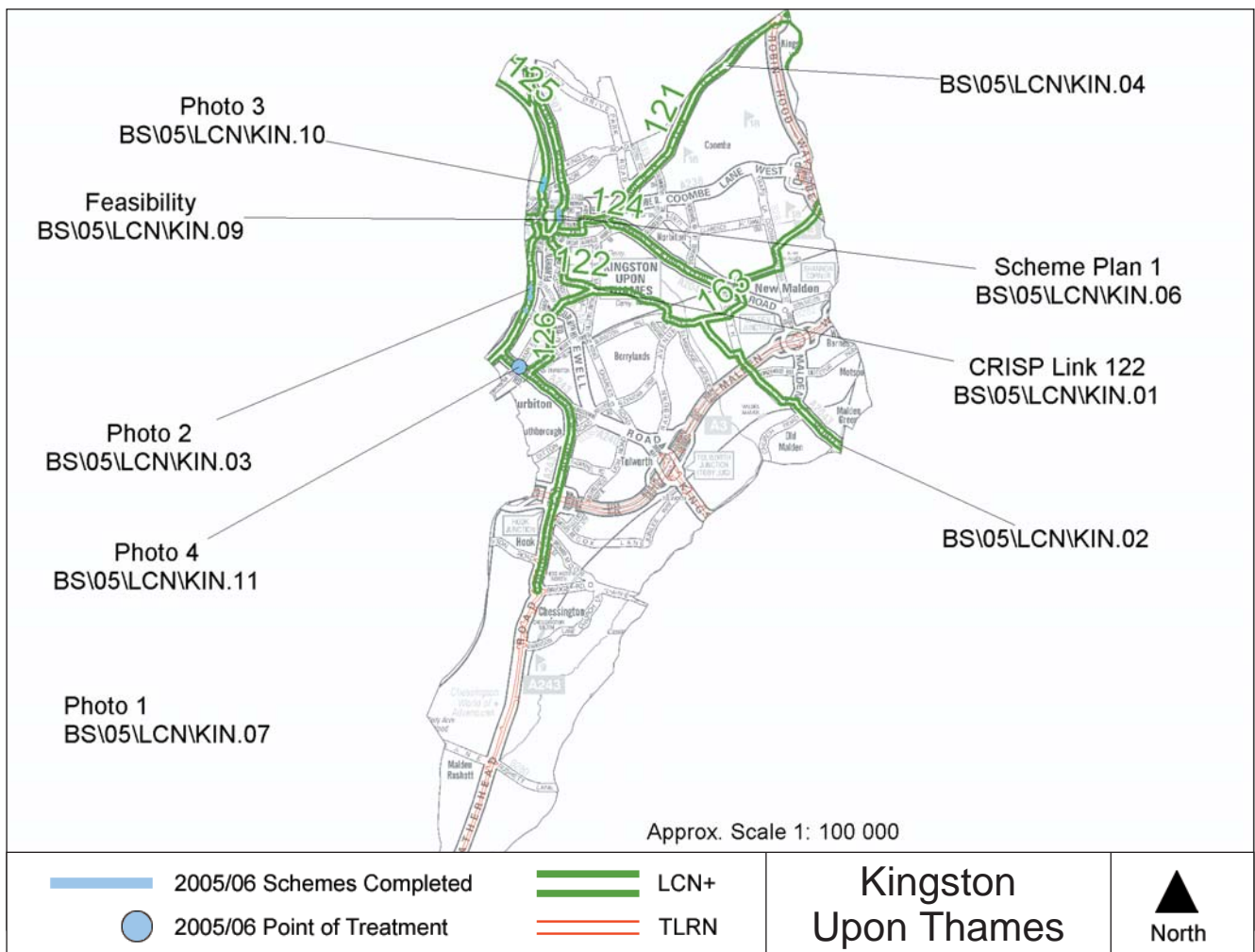



Scheme Photo: 1
Scheme Reference: BS\05\LCN\KIN.07
Location: Asset Management Initiative
Link number: All
Description: Repair of road surface defects on LCN+ Links to improve the quality of ride for cyclists.
Cost: £256,285

Scheme Plan:1
Scheme Reference: BS\05\LCN\KIN.06
Location: Castle Street
Link number: 122
Description: Design and introduce Vehicle Restricted Area in Castle Street with through access for cyclists. Traffic free section for cycle users and pedestrians from Kingston Town Centre towards Kingston Station.
Length: 0.14km
Cost: £125,000

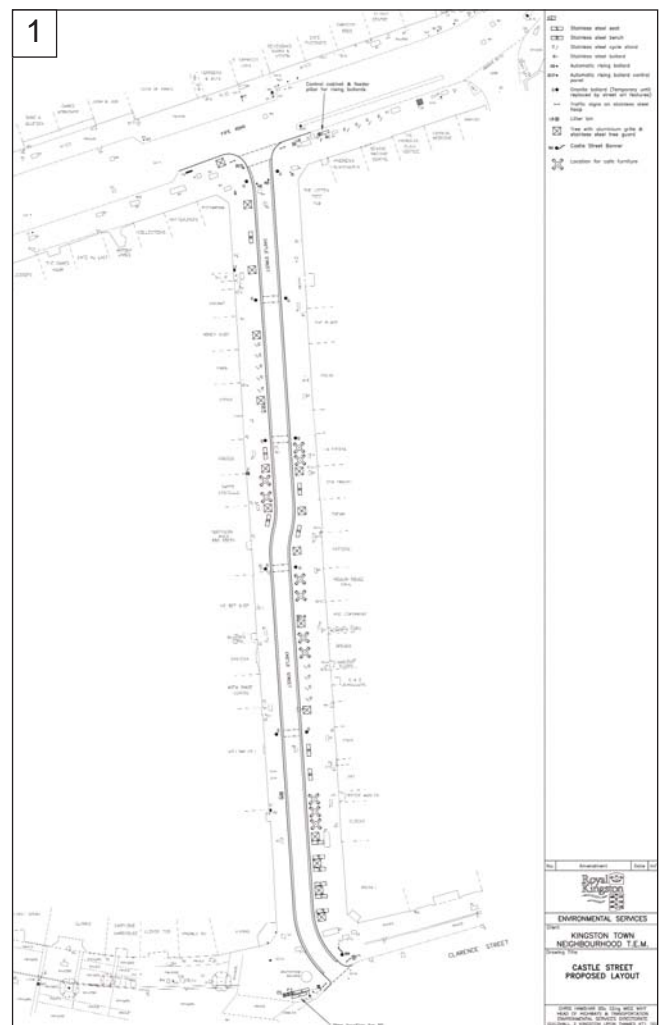



Scheme Photo : 2
Scheme Reference: BS\05\LCN\KIN.03
Location: A307 Portsmouth Road/High Street (Kingston Hall Road to Borough boundary)
Link number: 123
Description: Entry treatments at two side roads and kerb realignments. This scheme has also extended waiting and loading restrictions for Monday to Sunday to improve safety and continuity for cycle users southbound from Kingston towards Surbiton and Thames Ditton.
Length: 0.09km
Cost: £85,000

Scheme Photo : 3
Scheme Reference: BS\05\LCN\KIN.10
Location: Skerne Walk
Link number: 123
Description: As part of wider regeneration proposals to upgrade and redevelop sites in the north of Kingston Town the provision of a "green route" into the Town Centre along Skerne Road which forms part of LCN+ Route 75 and also connects towards the Thames Path (NCN 4).
Length: 0.22km
Cost: £30,000



Scheme Reference: BS\05\LCN\KIN.08
Location: Sector Leader Fees
Link number:
Description: Fees for the management and coordination of the South West Sector
Cost: £15,085

Scheme Reference: BS\05\LCN\KIN.04
Location: A308 Kingston Hill/Kingston Vale between Kingston Town Centre and A3/Borough Boundary
Link number: 121
Description: Review and upgrade signing along link into Kingston Town Centre. As part of a wider review of signing.
Length: 0.09km
Cost: £10,000



Scheme Photo: 4
Scheme Reference: BS\05\LCN\KIN.11
Location: A243 Brighton Road/Maple Road/Balaclava Road
Link number: 123
Description: Contribution towards a signals modernisation scheme including provision of advanced stop lines and pedestrian crossing facilities.
Cost: £5,000

Scheme Reference: BS\05\LCN\KIN.09
Location: London Road/Queen Elizabeth Road
Link number: 124
Description: Feasibility and design for upgrading cycle facilities as part of signals modernisation scheme. Implementation deferred until 2006/07.
Length: 0.13km **Cost:** £3,000

Scheme Reference: BS\05\LCN\KIN.02
Location: A2043 Malden Road, between Malden Green Avenue/Forest Side & Worcester Park Station
Link number: 122
Description: Feasibility and design contribution towards joint bus priority scheme to improve access towards Worcester Park station and Worcester Park High Street.
Cost: £2,366

CRISP: BS\05\LCN\KIN.01
Link number: 122
CRIM Undertaken: 06-Mar-06
Final CRISP Report: 28-Jul-06
Length: 7.01km
Cost: £10,580