

Wandsworth



Borough Officer: **Dalton Cenac**



I am situated within the highways and traffic department and utilise in-house consultants to design schemes whilst progressing the implementation through term contractors. According to the 2001 census 5% of journeys by residents were made by bicycle, this is higher than the London average and Wandsworth aims to maintain this. The Council actively encourages and promotes safe behaviour on bicycles through education and training, with publicity campaigns to raise road safety awareness. A major barrier to the delivery of a coherent and continuous cycle network was overcome in 2005/06 following the approval by the Secretary of State for Transport for the construction of segregated

shared use cycle paths across both Tooting Bec and Wandsworth Commons. Wandsworth is continuing to work closely with Sustrans and the Environment Agency to overcome other significant "missing links" along the Riverside Walk and at Earlsfield. The highways department has reviewed and enhanced its procedures to best utilise in-house resources and improve the quality of LCN+ service delivery by; rescheduling design and implementation works over a 24-month period and ensuring proper coordination, integration and stakeholder consultation on all Local Safety Schemes and Safer Routes To Schools schemes that include a significant cycling element. We have completed CRISP studies on four links with the remaining six ongoing at various stages.

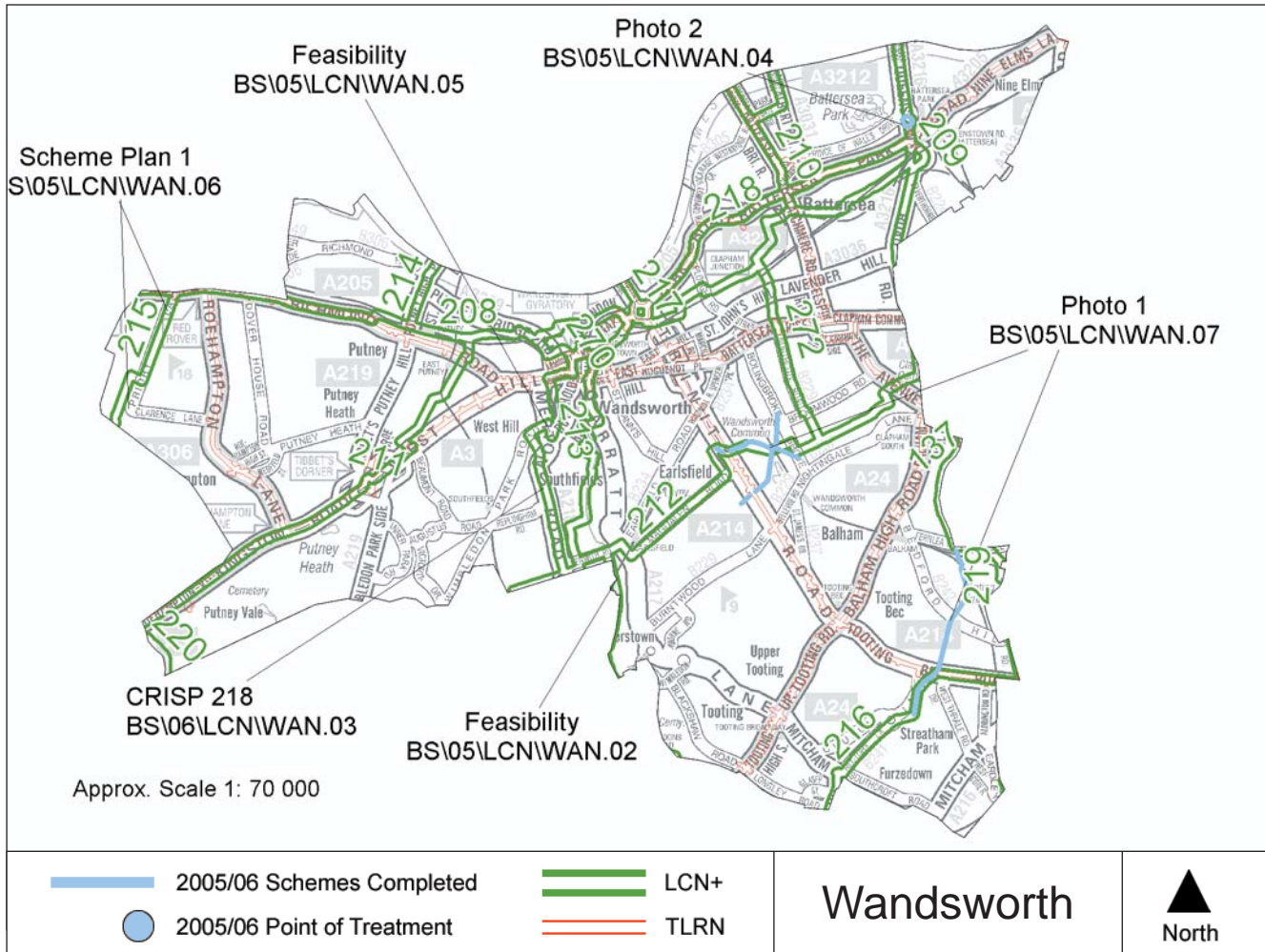

Scheme Photo: 1

Scheme Reference: BS\05\LCN\WAN.07
Location: Wandsworth & Tooting Common
Link number: 212
Description: New shared path across commons, including tactile paving & markings.
Length: 3.34km **Cost:** £80,000



Scheme Reference: BS\05\LCN\WAN.01
Location: Magdalen Road
Link number: 212
Description: Final invoices for raised tables and alterations to traffic management.
Length: 1.18km **Cost:** £26,000

Scheme Reference: BS\05\LCN\WAN.02
Location: Trewint Street to Ravensbury Terrace via River Wandle, Earlsfield
Link number: 218
Description: Feasibility and detailed design of a cycle and pedestrian bridge over the River Wandle between Summerley Street and Ravensbury Terrace (Link 218)
Length: 0.33km **Cost:** £10,000

Scheme Reference: BS\05\LCN\WAN.05
Location: Causeway to Buckhold Road
Link number: 213
Description: Feasibility study including origin and destination surveys to identify preferred desire line for cycle users towards Wandsworth Town Centre.
Cost: £5,000

Scheme Photo: 2

Scheme Reference: BS\05\LCN\WAN.04
Location: Queenstown Road between Chelsea Bridge (Borough Boundary) and Lavender Hill (Borough Boundary).
Link number: 209
Description: Contribution towards developer scheme to Queens Circus roundabout. Including cycle tracks, upgrade surface to shared area and widening central crossing refuges to improve comfort for cycle users and pedestrians.
Length: 0.80km **Cost:** £35,000

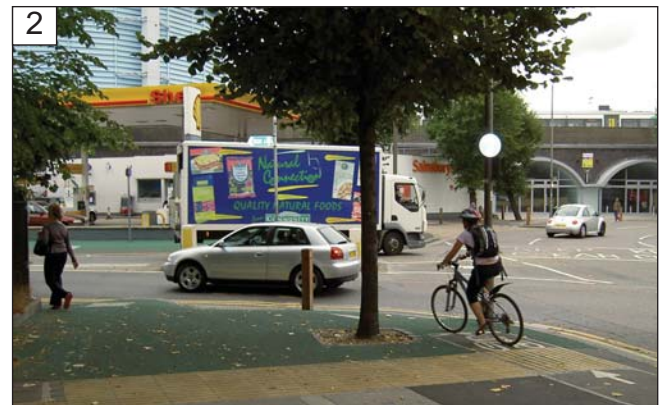
**Scheme Plan: 1**

Scheme Reference: BS\05\LCN\WAN.06
Location: Priory Lane **Link number:** 215
Description: Raised tables, traffic islands and mini roundabouts to reduce traffic speeds on link between Richmond Park and Barnes Common.
Length: 0.41km **Cost:** £50,000

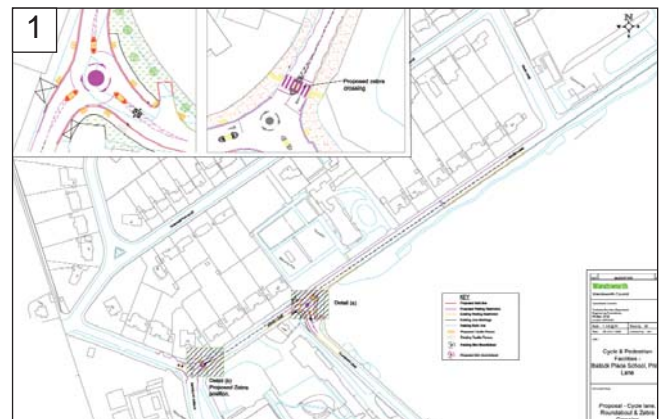

CRISP: BS\05\LCN\WAN.03
Link number: 270, 217, 218, 208(east)
Final CRISP Report: Delayed start to ensure completion of all other CRISP's from 2004/05. To be completed in 2006/07
Length: 9.79km **Cost:** £12,000